



# Dallas Love Field Community Weekly Update

IN THIS ISSUE

## Crazy little thing called Love... Field

By: Kevin Keith

### Announcements

The 2015 Turn Up! event at Dallas Love Field was a huge success this year, we anticipated 750 attendees and received over 1200! Special thanks to all those who planned and organized the event, and thanks to all those who attended, hope to see you next year!

#ExploreDallas

Visit [www.DallasCityOfLearning.org](http://www.DallasCityOfLearning.org) for more events.

You can follow Dallas Love Field on Facebook at: [www.facebook.com/DallasLoveField](http://www.facebook.com/DallasLoveField)

### Noise Complaints

You may still submit noise complaints to the Department of Aviation through the PublicVue portal on the Love Field website at [www.dallas-lovefield.com](http://www.dallas-lovefield.com) and clicking the "Aircraft Noise Complaints" button on the right side of the screen. You may also submit complaints via the Airport Communications Center at 214-670-LOVE (5683). The Airport Communications Center (ACC) is staffed 24 hours a day to direct your airport related concerns.



### Construction Updates

Page 2

### Runway Closures

Page 2

### Airport Diagram

Page 3

### Airport Operations Report

Pages 4-5

### Upcoming LFEAC Meetings...

Thursday October 8, 2015

Thursday January 14, 2016

Thursday April 14, 2016



# Construction Updates



## Runway Closures

### Scheduled Runway and Taxiway Closures

All closures will be coordinated through Airport Operations and will be permitted based on weather and operational impact.

- ❖ Sun/Aug 9th at 2330 – Mon/Aug 10th at 0500: Runway 13R/31L closed for Airfield Maintenance conducting pavement repairs and painting markings.
- ❖ Mon/Aug 10th at 2330 – Tue/Aug 11th at 0500: Taxiway B closed between ILS Hold line and the approach end of Runway 13L for Airfield maintenance painting taxiway markings.
- ❖ Tue/Aug 11th at 2330 – Wed/ Aug 12th at 0500: Taxiway C closed between the South entrance to Jet Aviation and the approach end of Runway 31L for painting taxiway markings.
- ❖ Wed/Aug 12th at 2330 – Thur/ Aug 13th at 0500: Runway 13L/31R closed for Airfield Maintenance painting runway markings.
- ❖ Thur/Aug 13th at 2330 – Fri/Aug 14th at 0500: Taxiway C5 between Runway 18/36 and Taxiway L and Taxiway L between Runway 18/36 and Taxiway K for Airfield Maintenance painting markings.

### Ongoing Airfield Closures

The following taxiways will remain closed until further notice:

- ❖ Taxiway D closed between Taxiway C and D1.
- ❖ Taxiway D1, ongoing daily closures, weather permitting, from 0700-1700 as required for work on the shoulder. Taxiway D will be available at Taxiway D1 intersection.
- ❖ Taxiway B closed between Taxiway B1 and Taxiway S for MCM pavement work.
- ❖ Taxiway P closed for RON C/Taxiway P realignment

\* Please see the airport diagram on the next page for locations of runways and taxiways.

15064

# AIRPORT DIAGRAM

AL-106 (FAA)

DALLAS-LOVE FIELD (DAL)  
DALLAS, TEXAS

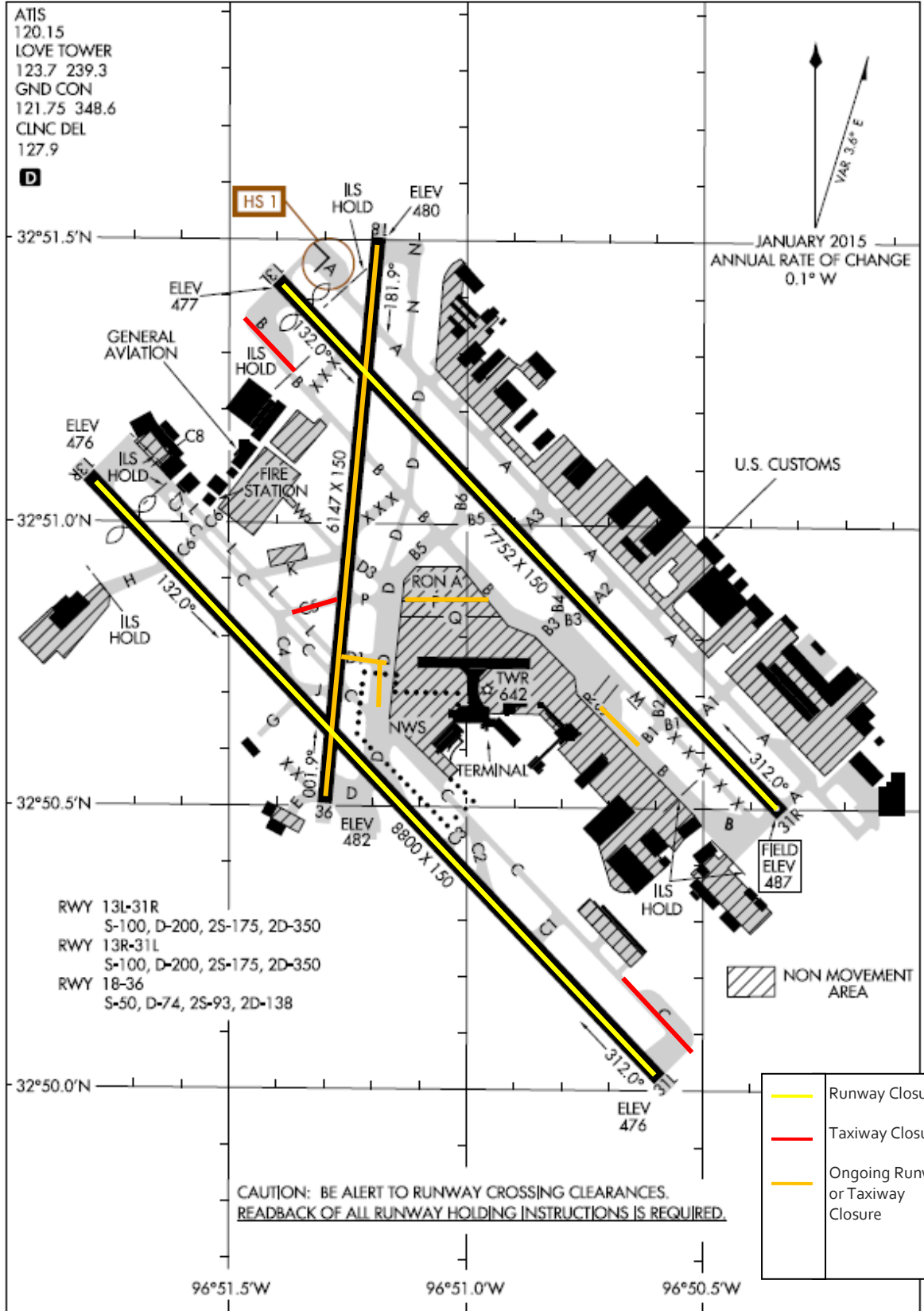

# AIRPORT DIAGRAM

15064

DALLAS, TEXAS  
DALLAS-LOVE FIELD (DAL)

# Airport Operations Report

All Operations for the Week of July 26 - August 1, 2015

	Runway 13L/31R (Lemmon)				Runway 13R/31L (Denton)			
	13L	31R	Total	Avg/Day	13R	31L	Total	Avg/Day
<b>ARRIVALS</b>	<b>1134</b>	<b>1</b>	<b>1135</b>	<b>162</b>	<b>831</b>	<b>1</b>	<b>832</b>	<b>119</b>
COMMERCIAL	662	0	662	95	606	0	606	87
GENERAL AVIATION	323	0	323	46	162	0	162	23
OTHER	149	1	150	21	62	1	63	9
<b>DEPARTURES</b>	<b>706</b>	<b>0</b>	<b>706</b>	<b>101</b>	<b>1317</b>	<b>2</b>	<b>1319</b>	<b>188</b>
COMMERCIAL	206	0	206	29	1062	0	1062	152
GENERAL AVIATION	348	0	348	50	165	1	166	24
OTHER	152	0	152	22	90	1	91	13

	Combined Operations	
<b>TOTAL ARRIVALS</b>	1967	281
<b>TOTAL DEPARTURES</b>	2025	289
<b>TOTAL OPERATIONS</b>	<b>3992</b>	<b>570</b>

\*Total arrival and departure counts include operations that are listed as "unknown" in the system due to radar coverage that doesn't correlate them with a runway in the Noise and Operations Monitoring System.

\*\*Aircraft classified as other include military operations, non-scheduled commercial operations such as charter flights/air taxi, and helicopter operations.

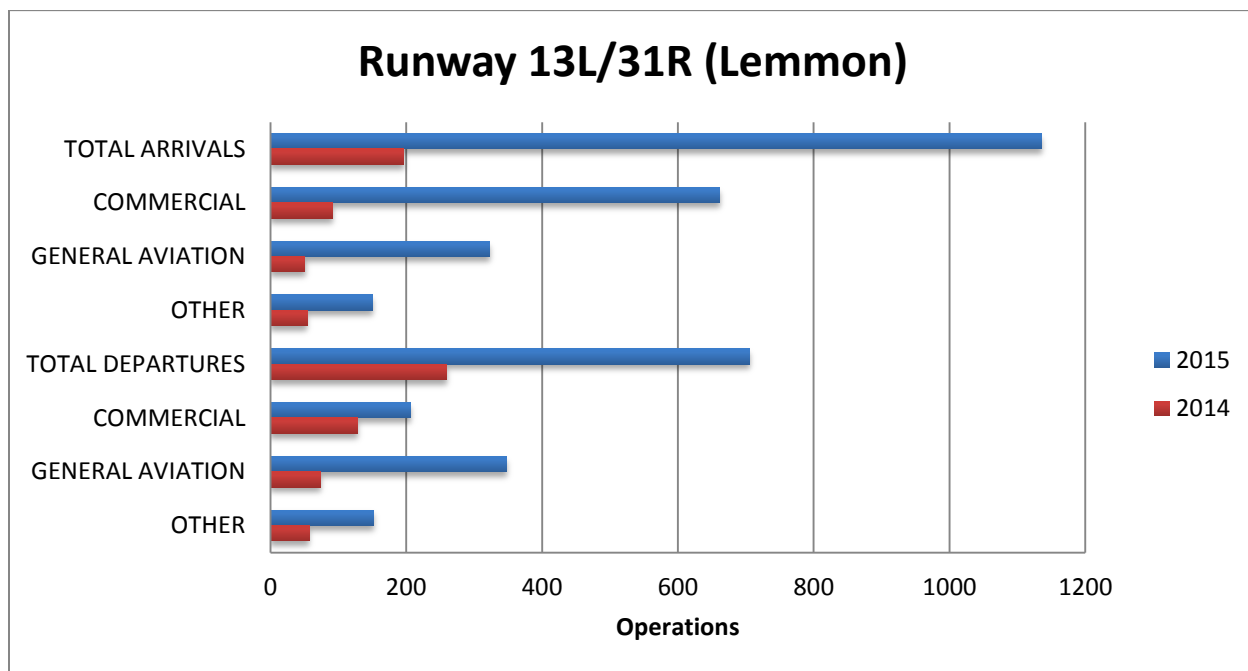

- July 14, 2014 – August 4, 2014: Runway 13L/31R was closed.
- Wed/Jul 29, 2015 at 2330 – Thur/Jul 30, 2015 at 0500: Runway 13L/31R closed

# Airport Operations Report Continued

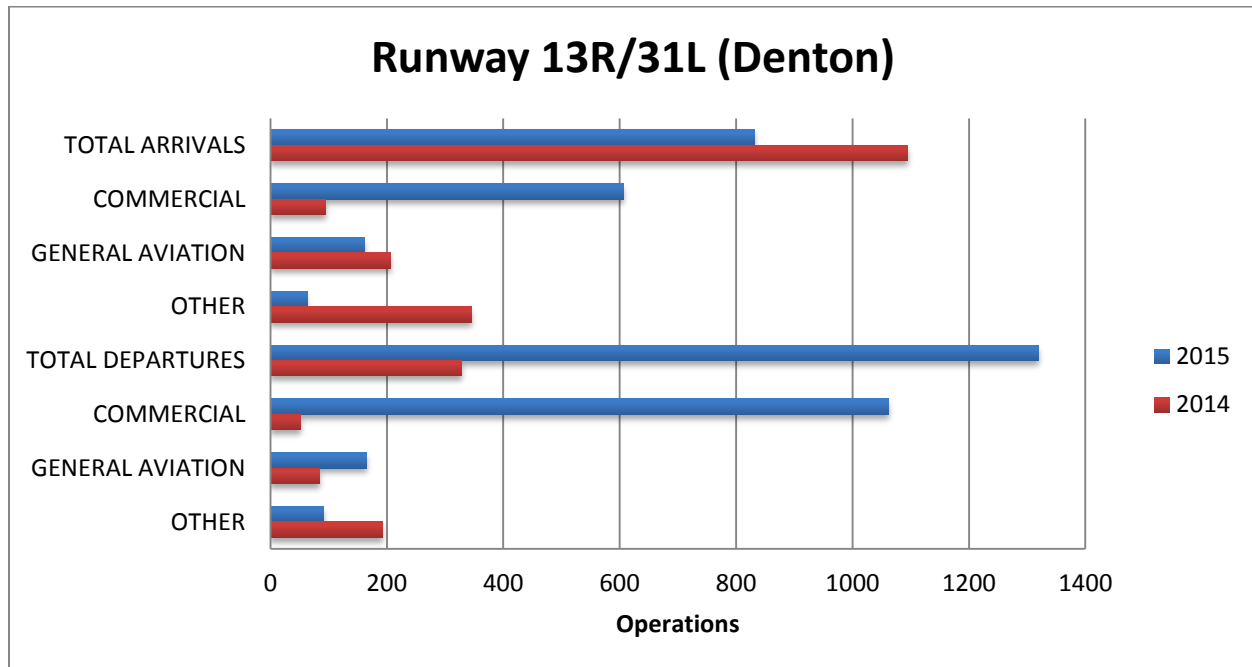

- Sun/July 26, 2015 at 2330 – Mon/July 27, 2015 at 0500: Runway 13R/31L was closed.

## Dallas Love Field

8008 Herb Kelleher Way LB 16

Dallas, Texas 75235

For questions or concerns please contact:

Kevin Keith

Environmental Operations Manager

214-670-6673

[Kevin.Keith@dallascityhall.com](mailto:Kevin.Keith@dallascityhall.com)



DALLAS LOVE FIELD  
**AIRPORT  
COMMUNICATION  
CENTER**

**ANSWERING ALL YOUR  
QUESTIONS AT LOVE FIELD**

**EMAIL 214670LOVE@DALLASCITYHALL.COM  
PHONE 214-670-LOVE (5683)**

In an effort to serve you better, Dallas Love Field has opened the Airport Communications Center (ACC) for your use. The ACC is staffed 24 hours a day to direct your airport related concerns. If you are submitting an aircraft noise complaint please call the ACC at 214-670-LOVE (5683). Complaints may also be submitted through the airport's aircraft noise and operations portal, PublicVue. To submit complaints through the PublicVue module, please visit [www.dallas-lovefield.com](http://www.dallas-lovefield.com) and click on "Aircraft Noise Complaints".