



Dallas Love Field Community Weekly Update

IN THIS ISSUE

Crazy little thing called Love... Field

By: Lanre Olaniyan

Announcements

In honor of National Dog Day make sure to bring your furry friends by Love Field's Dog Park. Dallas Love Field has a designated area for all pet relief needs should passengers choose to travel with their pets! You can find the pet relief area next to our baggage claim.

The smallest operator out of Dallas Love Field will be leaving the airport. Seaport Airlines flies a nine-seater Cessna Grand Caravan out of DAL until the change becomes effective September 12th. #DallasLoveField!

You can follow Dallas Love Field on Facebook at: www.facebook.com/DallasLoveField



Noise Complaints

You may still submit noise complaints to the Department of Aviation through the PublicVue portal on the Love Field website at www.dallas-lovefield.com and clicking the "Aircraft Noise Complaints" button on the right side of the screen. You may also submit complaints via the Airport Communications Center at 214-670-LOVE (5683). The Airport Communications Center (ACC) is staffed 24 hours a day to direct your airport related concerns.



Construction Updates

Page 2

Runway Closures

Page 2

Airport Diagram

Page 3

Airport Operations Report

Pages 4-5

Upcoming LFEAC Meetings...

Thursday October 8, 2015

Thursday January 14, 2016

Thursday April 14, 2016

Construction Updates

Runway Closures

Scheduled Runway and Taxiway Closures

All closures will be coordinated through Airport Operations and will be permitted based on weather and operational impact.

- Sun/Aug 30th at 2330 – Mon/Aug 31st at 0500: Runway 13R/31L closed for Airfield Maintenance painting shoulder markings, centerlines and taxiway lead off lines.
- Mon/Aug 31st at 2330 – Tue/Sept 1st at 0500: Taxiway C closed between Jet Aviation north ramp entrance and Taxiway C2 for Airfield Maintenance painting taxiway centerline, edge lines and enhanced centerline at Taxiway C1. The south entrance of Jet Aviation will remain open.
- Tue/Sept 1st at 2330 – Wed/ Sept 2nd at 0500: Taxiway C5 closed between Taxiway L and Runway 18/36 for Airfield Maintenance painting centerline and edge lines
- Wed/Sept 2nd at 2330 – Thur/ Sept 3rd at 0500: Runway 13L/31R closed for Airfield Maintenance painting runway centerline markings and taxiway leadoff lines.
- Thur/Sept 3rd at 2330 – Fri/Sept 4th at 0500: Taxiway C4 closed between Runway 13R/31L and Taxiway C for Airfield Maintenance painting centerline and edge markings.

Ongoing Airfield Closures

The following taxiways will remain closed until further notice:

- Taxiway D closed between Taxiway C and D1.
- Taxiway D1, closed as needed from 0700-1700 for work on the shoulder. Taxiway D will be available at Taxiway D1 intersection.
- Taxiway B closed between Taxiway B1 and Taxiway S for MCM pavement work.
- Taxiway P closed for RON C/Taxilane P realignment
- Taxiway D between Taxiway B & Taxilane Q, Taxiway B5 between Taxiways B & D and Taxiways D3 & D2 will be closed for 17 days for MCM installing taxiway lighting and other work associated with the relocation of Taxiway P.

*** Please see the airport diagram on the next page for locations of runways and taxiways.**

15064

AIRPORT DIAGRAM

AL-106 (FAA)

DALLAS-LOVE FIELD (DAL)
DALLAS, TEXAS

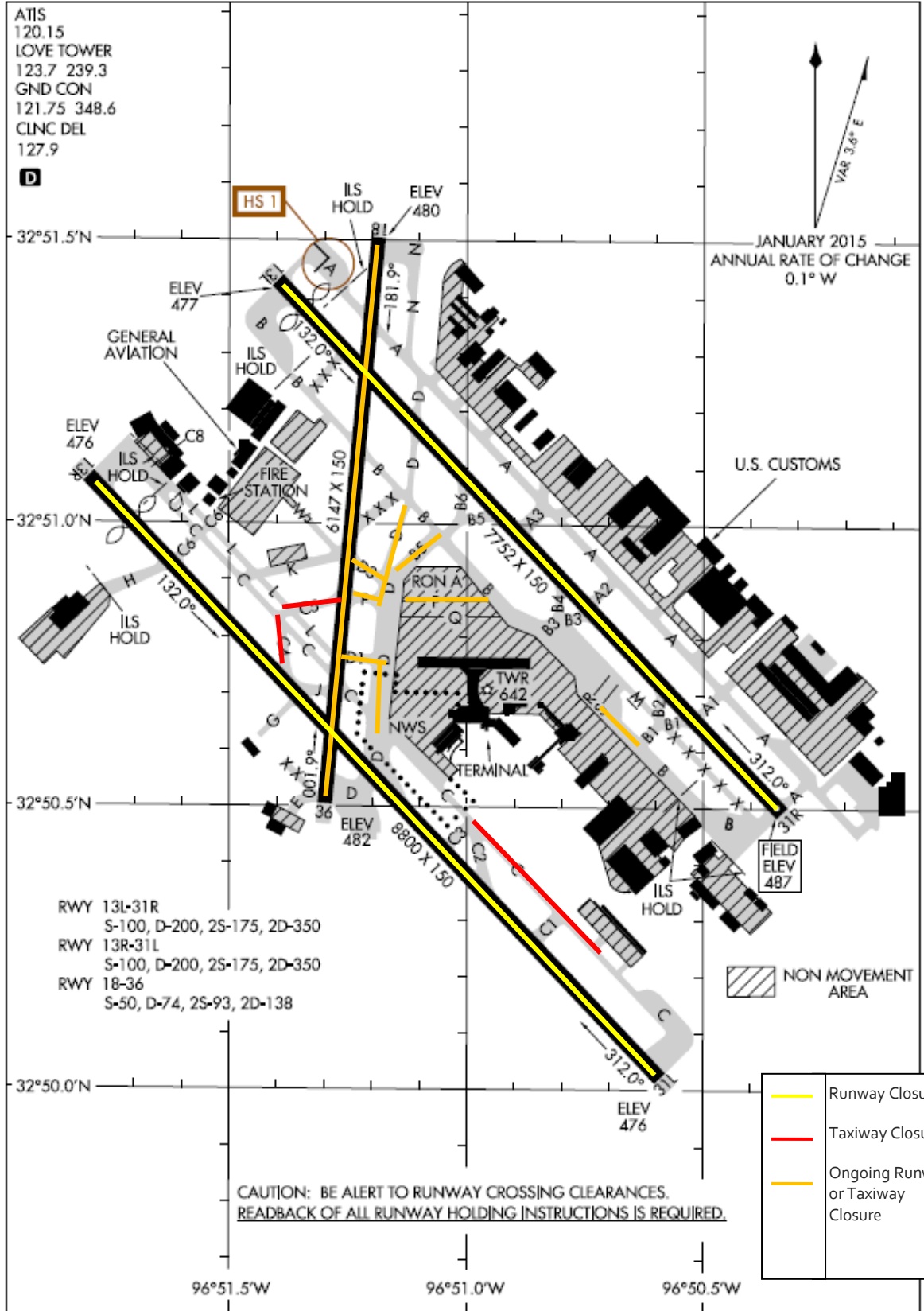

AIRPORT DIAGRAM

15064

DALLAS, TEXAS
DALLAS-LOVE FIELD (DAL)

Airport Operations Report

All Operations for the Week of August 16 - August 22, 2015

	Runway 13L/31R (Lemmon)				Runway 13R/31L (Denton)			
	13L	31R	Total	Avg/Day	13R	31L	Total	Avg/Day
ARRIVALS	1092	101	1193	170	726	92	818	117
COMMERCIAL	670	48	718	103	537	71	608	87
GENERAL AVIATION	296	41	337	48	143	13	156	22
OTHER	126	12	138	20	45	8	53	8
DEPARTURES	826	134	960	137	1031	69	1100	157
COMMERCIAL	387	69	456	65	840	48	888	127
GENERAL AVIATION	304	49	353	50	124	15	139	20
OTHER	135	16	151	22	66	6	72	10

	Combined Operations	
TOTAL ARRIVALS	2011	287
TOTAL DEPARTURES	2060	294
TOTAL OPERATIONS	4071	582

*Total arrival and departure counts include operations that are listed as "unknown" in the system due to radar coverage that doesn't correlate them with a runway in the Noise and Operations Monitoring System.

**Aircraft classified as other include military operations, non-scheduled commercial operations such as charter flights/air taxi, and helicopter operations.

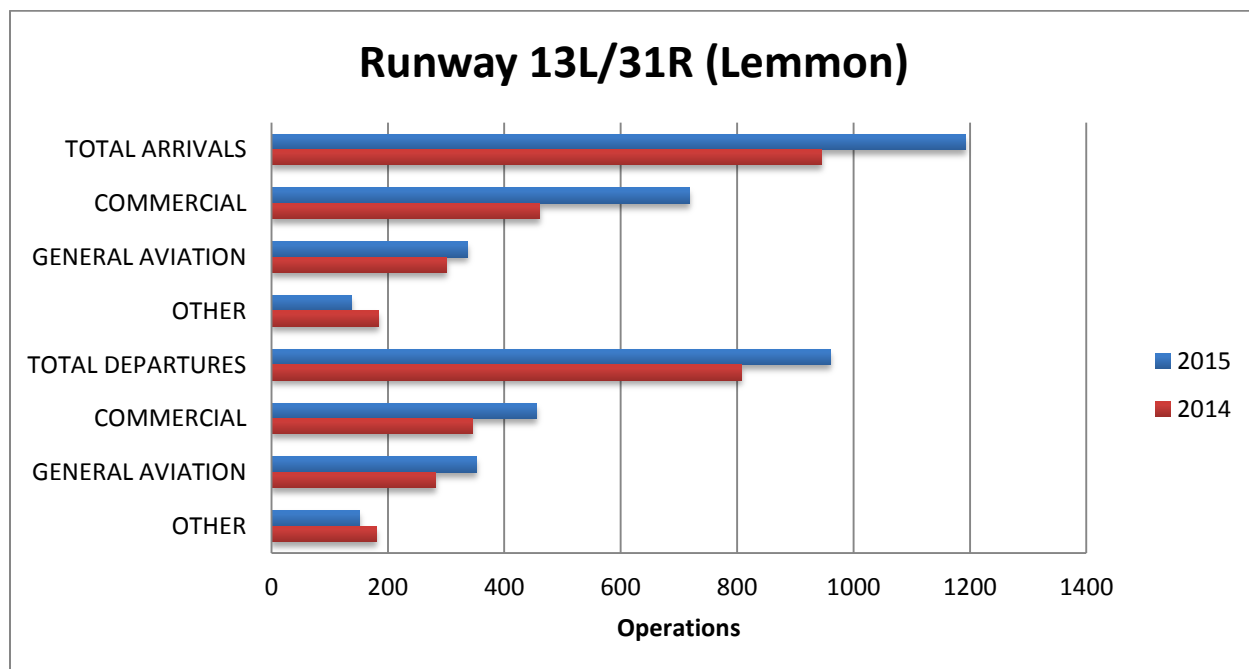

- Sun/Aug 17, 2014 at 2330 – Mon/Aug 18, 2014: Runway 13L/31R was closed.
- Wed/Aug 19, 2015 at 2330 – Thur/Aug 20, 2015 at 0500: Runway 13L/31R closed

Airport Operations Report Continued

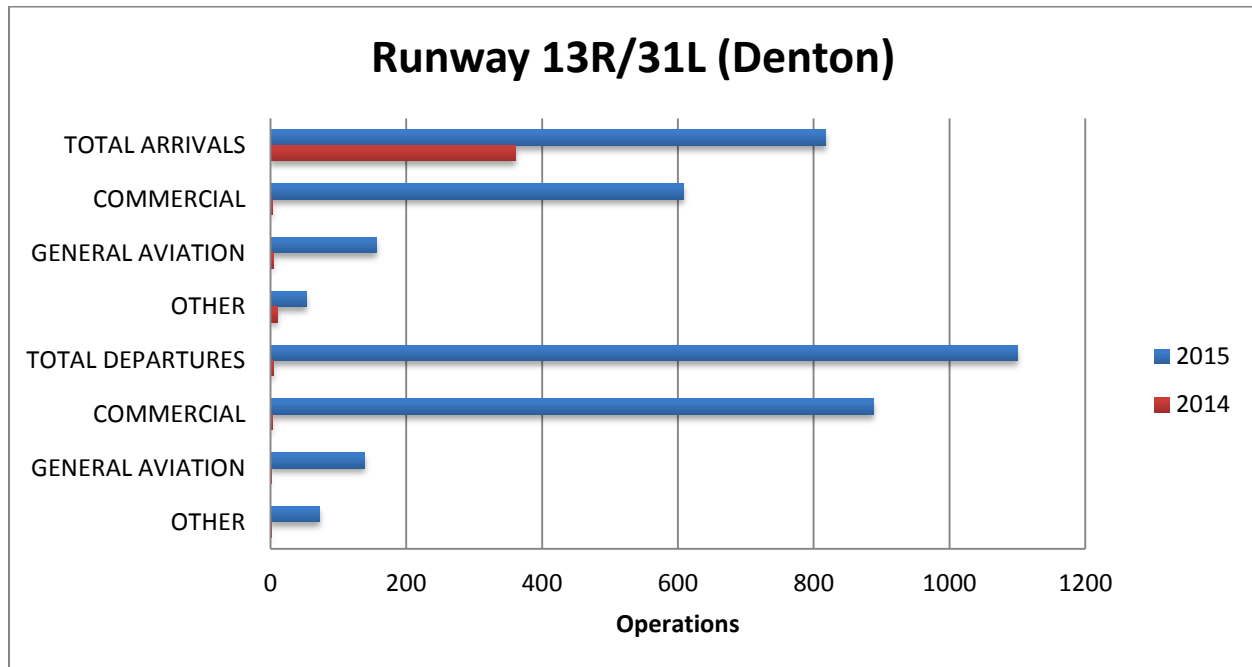

- Wed/ Aug 20, 2014 at 2300 – Thu/Aug 21 at 0530: Runway 13R/31L was closed
- TWY C between C2 and D closed to aircraft August 2014
- Sun/Aug 16, 2015 at 2330 – Mon/Aug 17, 2015 at 0500: Runway 13R/31L was closed.

Dallas Love Field

8008 Herb Kelleher Way LB 16

Dallas, Texas 75235

For questions or concerns please contact:

Lanre Olaniyan

Interim Airport Noise Coordinator

214-670-6673

Olanrewaju.Olaniyan@dallascityhall.com



**DALLAS LOVE FIELD
AIRPORT
COMMUNICATION
CENTER**

**ANSWERING ALL YOUR
QUESTIONS AT LOVE FIELD**

**EMAIL 214670LOVE@DALLASCITYHALL.COM
PHONE 214-670-LOVE (5683)**

In an effort to serve you better, Dallas Love Field has opened the Airport Communications Center (ACC) for your use. The ACC is staffed 24 hours a day to direct your airport related concerns. If you are submitting an aircraft noise complaint please call the ACC at 214-670-LOVE (5683). Complaints may also be submitted through the airport's aircraft noise and operations portal, PublicVue. To submit complaints through the PublicVue module, please visit www.dallas-lovefield.com and click on "Aircraft Noise Complaints".