



Dallas Love Field Community Weekly Update

IN THIS ISSUE

Crazy little thing called Love... Field

By: Lanre Olaniyan

Announcements

The PINK "B & G" arrived at Dallas Love Field baggage claim on Thursday, October 22, 2015. Passengers of Love Field made a point to stop by to take a photo and show their support for Breast Cancer Awareness. Employees of Dallas Love Field were encouraged to wear pink as well as take time to research and make a donation to any Breast Cancer Awareness site or organization.

Dallas Love Field is 98 years old!!! October 19, 1917: Love Field was opened as an Army flying field. Thank you to everyone who has been a part of Dallas Love Field's 98 years of history. Help us celebrate 98 years of LOVE!

#HappyBirthdayDallasLoveField



Noise Complaints

You may submit noise complaints to the Department of Aviation through the PublicVue portal on the Love Field website at www.dallas-lovefield.com and clicking the "Aircraft Noise Complaints" button on the right side of the screen. You may also submit complaints via the Airport Communications Center at 214-670-LOVE (5683). The Airport Communications Center (ACC) is staffed 24 hours a day to direct your airport related concerns.



Construction Updates

Page 2

Runway Closures

Page 2

Airport Diagram

Page 3

Airport Operations Report

Pages 4-5

Upcoming LFEAC Meetings...

Thursday January 14, 2016

Thursday April 14, 2016

Thursday July 14, 2016

Construction Updates

Runway Closures

Scheduled Runway and Taxiway Closures

All closures will be coordinated through Airport Operations and will be permitted based on weather and operational impact.

- Sun/Oct 25th at 23:30 – Mon/Oct 26th at 05:00: Runway 13R/31L closed for Airfield Maintenance contractor painting runway markings
- Tues/Oct 27th at 2330 – Wed/Oct 28th at 0530: Runway 13L/31R and Taxiway S, Taxiway B (between Taxiways R and B1) and Taxiway M (between Taxiways R and B1) will be closed for AT&T pulling fiber-optic cable.
- Wed/Oct 28th at 2330 – Thur/Oct 29th at 0500: Runway 13L/31R and Taxiway A (between Taxiways A1 and A2) will be closed for AT&T pulling fiber optic cable.
- Wed/Oct 28th at 2330 – Thur/Oct 29th at 0500: Runway 13L/31R closed for Airfield Maintenance contractor painting runway markings

Ongoing Airfield Closures

The following taxiways will remain closed until further notice:

- No ongoing closures in effect

* Please see the airport diagram on the next page for locations of runways and taxiways.

15232

AIRPORT DIAGRAM

AL-106 (FAA)

DALLAS LOVE FIELD (DAL)
DALLAS, TEXAS

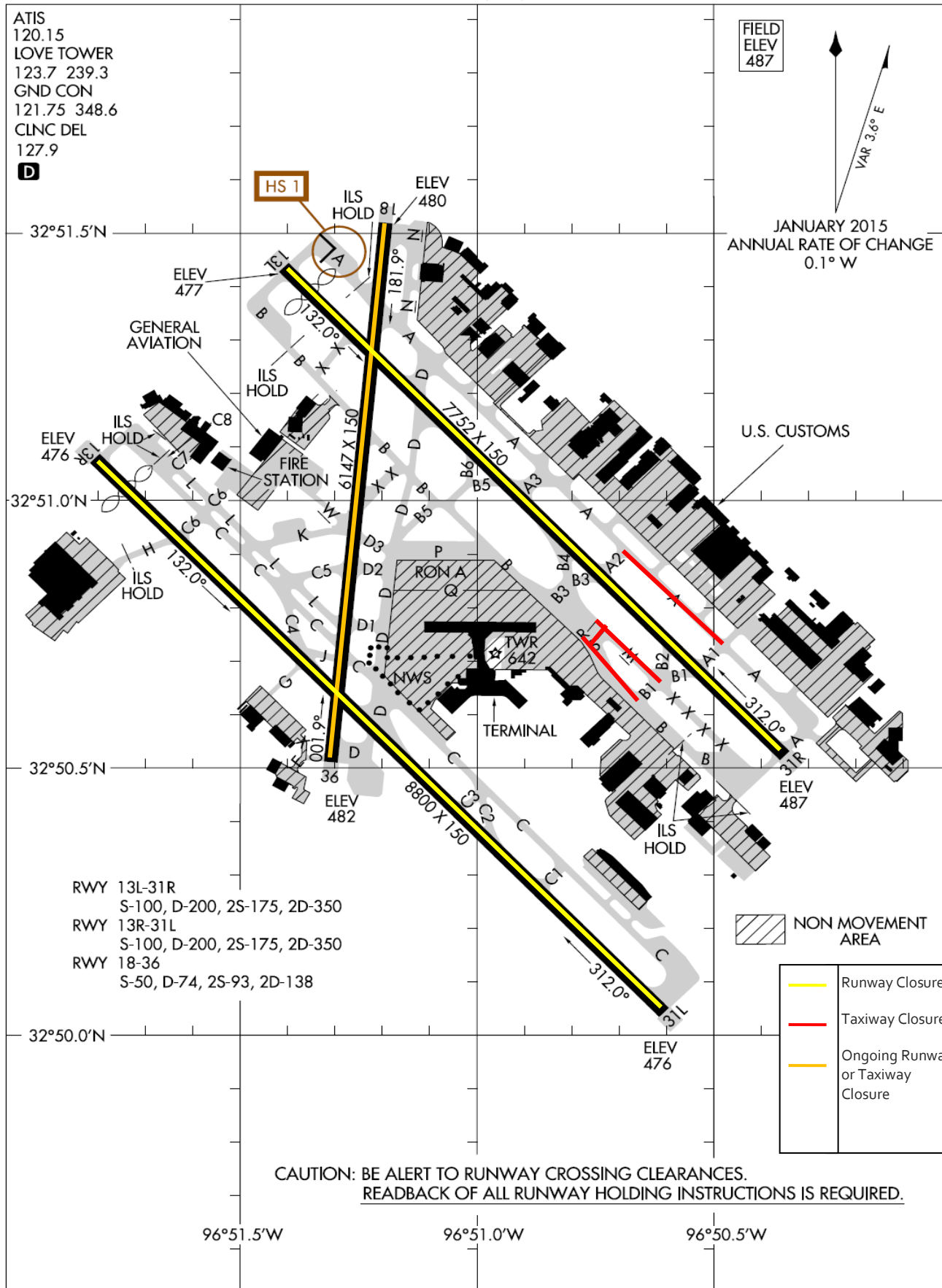

AIRPORT DIAGRAM

15232

DALLAS, TEXAS
DALLAS LOVE FIELD (DAL)

Airport Operations Report

All Operations for the Week of October 11 - October 17, 2015

	Runway 13L/31R (Lemmon)				Runway 13R/31L (Denton)			
	13L	31R	Total	Avg/Day	13R	31L	Total	Avg/Day
ARRIVALS	1018	273	1291	184	665	352	1017	145
COMMERCIAL	500	88	588	84	474	288	762	109
GENERAL AVIATION	375	131	506	72	146	42	188	27
OTHER	143	54	197	28	43	19	62	9
DEPARTURES	826	369	1195	171	936	265	1201	172
COMMERCIAL	276	185	461	66	703	196	899	128
GENERAL AVIATION	378	121	499	71	163	47	210	30
OTHER	172	63	235	34	68	21	89	13

	Total Ops Combined	Total Ops Average
TOTAL ARRIVALS	2308	330
TOTAL DEPARTURES	2396	342
TOTAL OPERATIONS	4704	672

*Total arrival and departure counts include operations that are listed as "unknown" in the system due to radar coverage that doesn't correlate them with a runway in the Noise and Operations Monitoring System.

**Aircraft classified as other include military operations, non-scheduled commercial operations such as charter flights/air taxi, and helicopter operations.

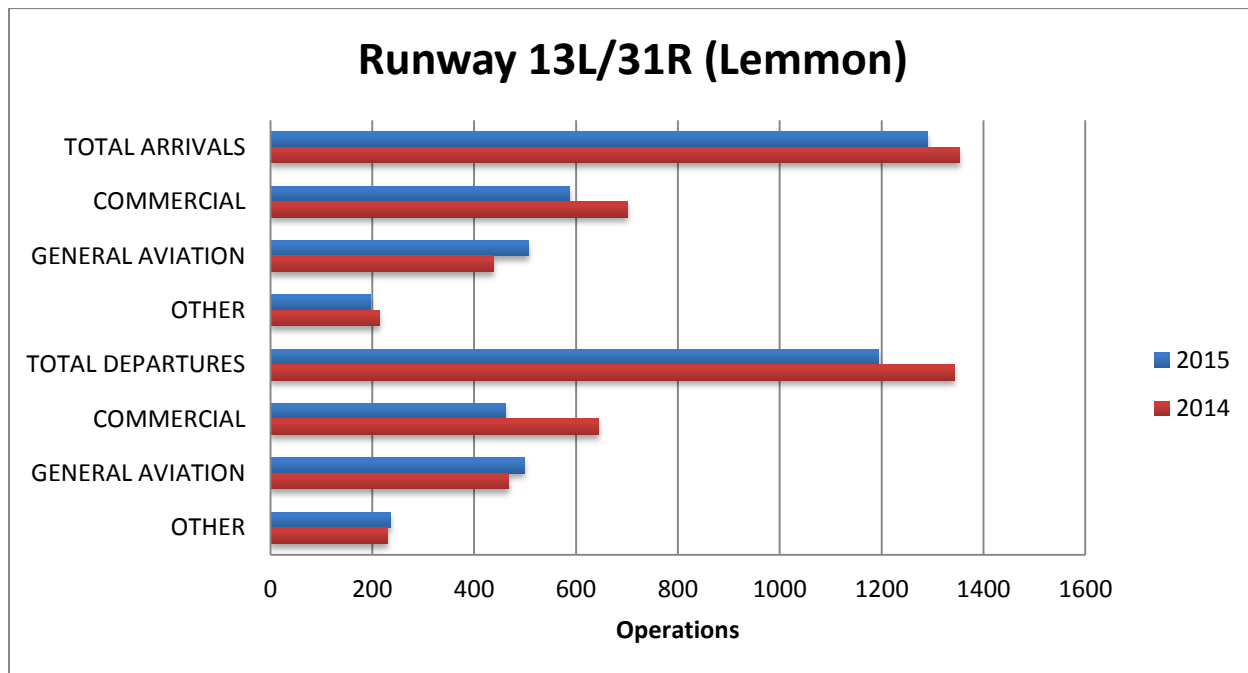

- Sun/Oct. 12 , 2014 at 2300 – Mon/Oct. 13, 2014 at 0530: Runway 13L/31R was closed.
- Tue/Oct. 14, 2014 at 2300 – Wed/ Oct. 15, 2014 at 0530: Runway 13L/31R was closed.
- Wed/Oct. 14, 2015 at 2330 – Thur/Oct. 15, 2015 at 0500: Runway 13L/31R was closed.

Airport Operations Report Continued

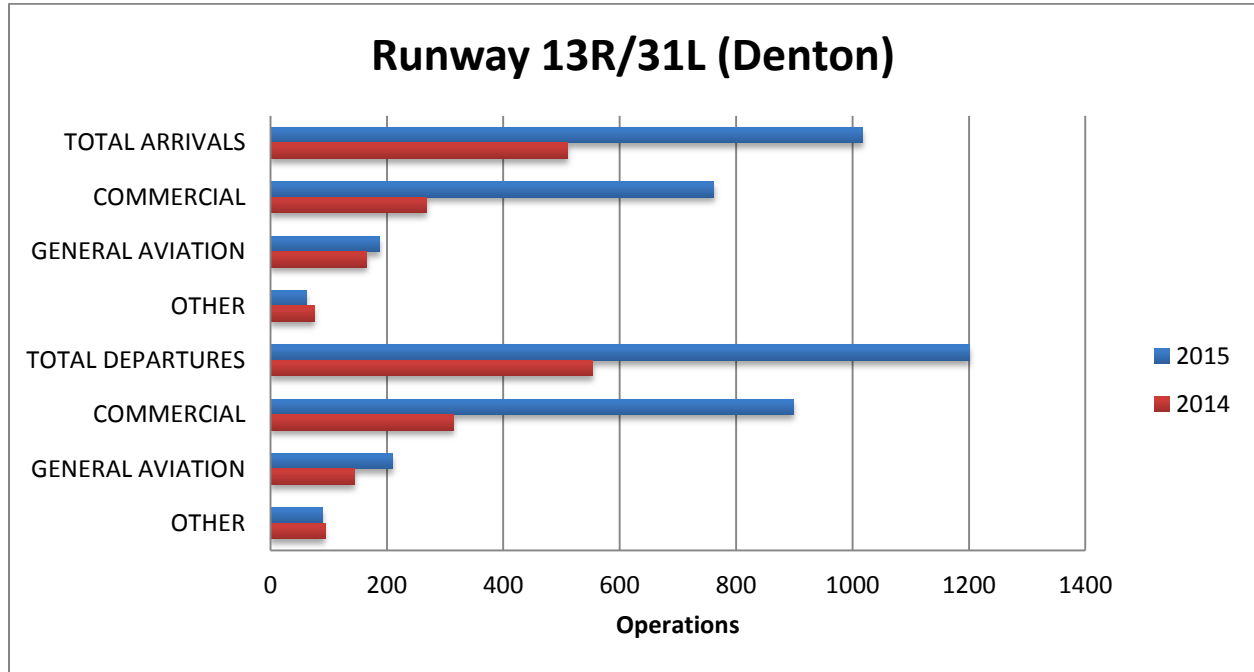

- Wed/Oct. 15, 2014 at 2300 – Thur/Oct.16, 2014 at 0530: Runway 13R/31L was closed
- TWY C closed between C6 and the approach end of RWY 13R, TWY C closed between C6 and C5, and C8 between TWY L and C. Closure started Wed/Oct. 15 until Fri/Oct. 24.
- Sun/Oct. 11, 2015 at 2330 – Mon/Oct. 12, 2015 at 0500: Runway 13R/31L was closed.

Dallas Love Field

8008 Herb Kelleher Way LB 16
 Dallas, Texas 75235

For questions or concerns please contact:

Lanre Olaniyan
 Interim Airport Noise Coordinator
 214-670-6673
Olanrewaju.Olaniyan@dallascityhall.com

**DALLAS LOVE FIELD
 AIRPORT
 COMMUNICATION
 CENTER**

**ANSWERING ALL YOUR
 QUESTIONS AT LOVE FIELD**

**EMAIL 214670LOVE@DALLASCITYHALL.COM
 PHONE 214-670-LOVE (5683)**

In an effort to serve you better, Dallas Love Field has opened the Airport Communications Center (ACC) for your use. The ACC is staffed 24 hours a day to direct your airport related concerns. If you are submitting an aircraft noise complaint please call the ACC at 214-670-LOVE (5683). Complaints may also be submitted through the airport’s aircraft noise and operations portal, PublicVue. To submit complaints through the PublicVue module, please visit www.dallas-lovefield.com and click on “Aircraft Noise Complaints”.