



# Dallas Love Field Community Weekly Update

IN THIS ISSUE

## Crazy little thing called Love... Field

By: Lanre Olaniyan

### Announcements

Visit Frontiers of Flight Museum October 30<sup>th</sup> – November 1<sup>st</sup> for an amazing experience. Step back into the time of WWII on one of the few airworthy B-17's in the world, from the Experimental Aircraft Association, Chapter 34. Feel the might of the "Flying Fortress" 65'000 lb B-17 as it soars through the sky.

**Please be advised that there could be an increase of general aviation traffic due to these games:**

The Dallas Cowboys will be hosting the Seattle Seahawks at AT&T Stadium in Arlington on Sunday November 1<sup>st</sup>, 2015.

The Dallas Mavericks will be hosting the Toronto Raptors on Tuesday November 3<sup>rd</sup>, 2015 and the Charlotte Hornets on Thursday November 5<sup>th</sup>, 2015 at the American Airlines Center.



### Noise Complaints

You may submit noise complaints to the Department of Aviation through the PublicVue portal on the Love Field website at [www.dallas-lovefield.com](http://www.dallas-lovefield.com) and clicking the "Aircraft Noise Complaints" button on the right side of the screen. You may also submit complaints via the Airport Communications Center at 214-670-**LOVE** (5683). The Airport Communications Center (ACC) is staffed 24 hours a day to direct your airport related concerns.

AVI-FRM-404, V2, Eff. 08/18/15



### Construction Updates

Page 2

### Runway Closures

Page 2

### Airport Diagram

Page 3

### Airport Operations Report

Pages 4-5

### Upcoming LFEAC Meetings...

Thursday January 14, 2016

Thursday April 14, 2016

Thursday July 14, 2016

# Construction Updates

## Runway Closures

### Scheduled Runway and Taxiway Closures

All closures will be coordinated through Airport Operations and will be permitted based on weather and operational impact.

- Sun/Nov 1<sup>st</sup> 06:00 – 10:00: Runway 13R/31L closed for FAA Tech Ops conducting maintenance on the approach lighting and AVI/Electricians cleaning lenses on runway lighting.
- Sun/Nov 1<sup>st</sup> 10:00 – 12:00: Runway 13L/31R closed for FAA Tech Ops conducting maintenance on the approach lighting and AVI/Electricians cleaning lenses on runway lighting.
- Sun/Nov 1<sup>st</sup> at 22:00 – Mon/Nov 2<sup>nd</sup> at 05:00: Runway 13R/31L closed for Airfield Maintenance mowing in the runway safety area, removing rubber and contractor painting runway markings
- Tues/Nov 3<sup>rd</sup> at 2330 – Wed/Nov 4<sup>th</sup> at 0530: Runway 13L/31R and Taxiway S, Taxiway B (between Taxiways R and B1) and Taxiway M (between Taxiways R and B1) will be closed for AT&T pulling fiber-optic cable.
- Wed/Nov 4<sup>th</sup> at 2330 – Thur/Nov 5<sup>th</sup> at 0500: Runway 13L/31R and Taxiway A (between Taxiways A1 and A2) will be closed for AT&T pulling fiber optic cable.
- Wed/Nov 4<sup>th</sup> at 22:00 – Thur/Nov 5<sup>th</sup> at 0500: Runway 13L/31R closed for Airfield Maintenance contractor painting runway markings

### Ongoing Airfield Closures

The following taxiways will remain closed until further notice:

- No ongoing closures in effect

15232

# AIRPORT DIAGRAM

AL-106 (FAA)

DALLAS LOVE FIELD (DAL)  
DALLAS, TEXAS

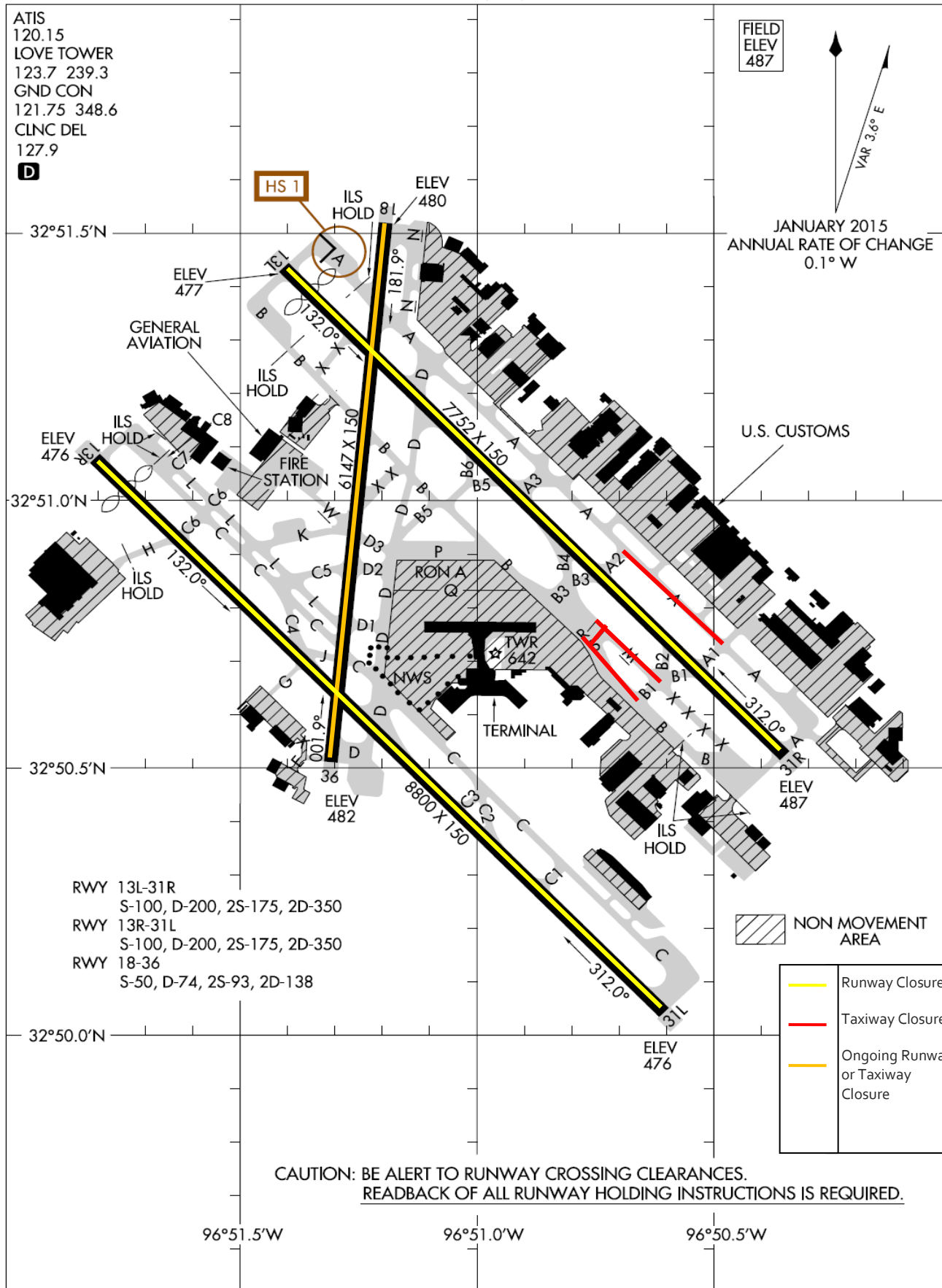

# AIRPORT DIAGRAM

15232

DALLAS, TEXAS  
DALLAS LOVE FIELD (DAL)

# Airport Operations Report

All Operations for the Week of October 18 - October 24, 2015

	Runway 13L/31R (Lemmon)				Runway 13R/31L (Denton)			
	13L	31R	Total	Avg/Day	13R	31L	Total	Avg/Day
<b>ARRIVALS</b>	<b>1058</b>	<b>115</b>	<b>1173</b>	<b>168</b>	<b>775</b>	<b>174</b>	<b>949</b>	<b>136</b>
COMMERCIAL	546	53	599	86	578	145	723	103
GENERAL AVIATION	347	31	378	54	144	18	162	23
OTHER	165	31	196	28	48	10	58	8
<b>DEPARTURES</b>	<b>868</b>	<b>150</b>	<b>1018</b>	<b>145</b>	<b>1077</b>	<b>99</b>	<b>1176</b>	<b>168</b>
COMMERCIAL	319	88	407	58	839	82	921	132
GENERAL AVIATION	354	33	387	55	186	8	194	28
OTHER	195	29	224	32	49	9	58	8

	Total Ops Combined	Total Ops Average
<b>TOTAL ARRIVALS</b>	2122	303
<b>TOTAL DEPARTURES</b>	2194	313
<b>TOTAL OPERATIONS</b>	<b>4316</b>	<b>617</b>

\*Total arrival and departure counts include operations that are listed as "unknown" in the system due to radar coverage that doesn't correlate them with a runway in the Noise and Operations Monitoring System.

\*\*Aircraft classified as other include military operations, non-scheduled commercial operations such as charter flights/air taxi, and helicopter operations.

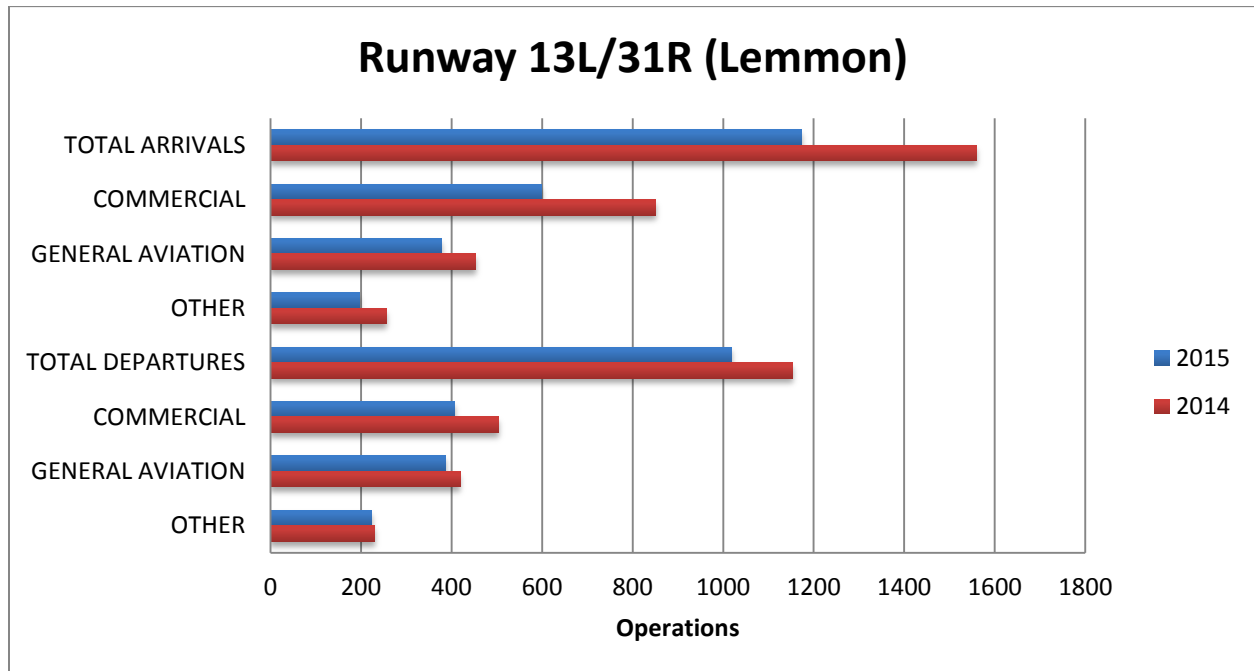

- No reported closure of RWY 13L/31R from October 18, 2014 – October 24, 2014.
- Wed/Oct. 21, 2015 at 2330 – Thur/Oct.22, 2015 at 0500: Runway 13L/31R was closed.

# Airport Operations Report Continued

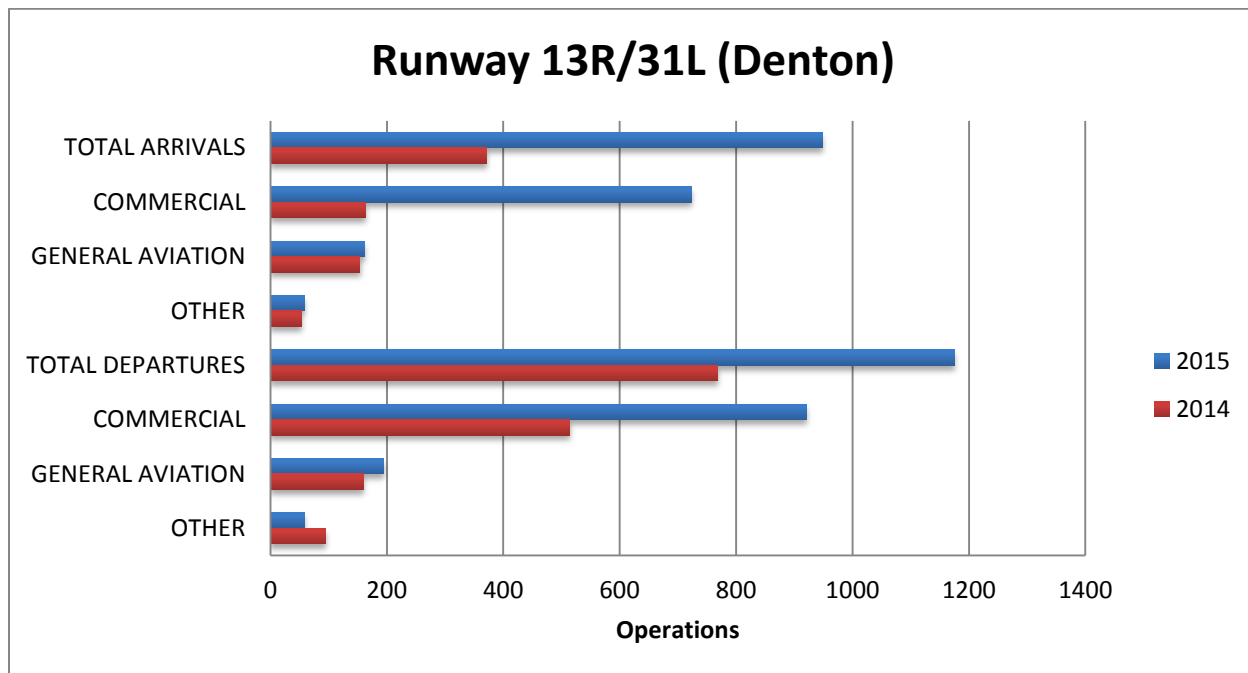

- No reported closure of RWY 13L/31R from October 18, 2014 – October 24, 2014
- Sun/Oct.18, 2015 at 2330 – Mon/Oct. 19, 2015 at 0500: Runway 13R/31L was closed.

## Dallas Love Field

8008 Herb Kelleher Way LB 16

Dallas, Texas 75235

For questions or concerns please contact:

Lanre Olaniyan

Interim Airport Noise Coordinator

214-670-6673

[Olanrewaju.Olaniyan@dallascityhall.com](mailto:Olanrewaju.Olaniyan@dallascityhall.com)

**DALLAS LOVE FIELD  
AIRPORT  
COMMUNICATION  
CENTER**

ANSWERING ALL YOUR  
QUESTIONS AT LOVE FIELD

**EMAIL 214670LOVE@DALLASCITYHALL.COM  
PHONE 214-670-LOVE (5683)**

In an effort to serve you better, Dallas Love Field has opened the Airport Communications Center (ACC) for your use. The ACC is staffed 24 hours a day to direct your airport related concerns. If you are submitting an aircraft noise complaint please call the ACC at 214-670-LOVE (5683). Complaints may also be submitted through the airport's aircraft noise and operations portal, PublicVue. To submit complaints through the PublicVue module, please visit [www.dallas-lovefield.com](http://www.dallas-lovefield.com) and click on "Aircraft Noise Complaints".