



Dallas Love Field Community Weekly Update

\$6 DAILY RATE PARKING

IN THIS ISSUE

Crazy little thing called Love... Field

By: Lanre Olaniyan

Announcements

Dallas Love Field has a new remote parking location named...THE LOVE CONNECTION. THE LOVE CONNECTION is opening September 21st and is just down the street from Dallas Love Field. The parking lot address will be 6814 Harry Hines Blvd. It will operate 24/7 and remember it is only \$6/day!

Congratulations to DPD Officer Christopher Crites nominated as Officer of the Quarter at Dallas Love Field. Officer Crites was recognized for his performance, teamwork, compassion, incident management, among many other exceptional traits and qualities as a DPD officer assigned to Love Field Airport. Thank you for your service Officer Crites!

You can follow Dallas Love Field on Facebook at: www.facebook.com/DallasLoveField



Noise Complaints

You may still submit noise complaints to the Department of Aviation through the PublicVue portal on the Love Field website at www.dallas-lovefield.com and clicking the "Aircraft Noise Complaints" button on the right side of the screen. You may also submit complaints via the Airport Communications Center at 214-670-LOVE (5683). The Airport Communications Center (ACC) is staffed 24 hours a day to direct your airport related concerns.



Construction Updates

Page 2

Runway Closures

Page 2

Airport Diagram

Page 3

Airport Operations Report

Pages 4-5

Upcoming LFEAC Meetings...

Thursday October 8, 2015

Thursday January 14, 2016

Thursday April 14, 2016

Construction Updates

Runway Closures

Scheduled Runway and Taxiway Closures

All closures will be coordinated through Airport Operations and will be permitted based on weather and operational impact.

- Sun/Sept 20th at 23:30 – Mon/Sept 21st at 05:00: Runway 13R/31LR closed for Airfield Maintenance conducting runway maintenance activities.
- Sun/Sept 20th at 23:30 – Mon/Sept 21st at 05:00: Taxiway D1 and Taxiway D between the existing construction area closure and Taxilane Q will be closed for MCM painting taxiway markings and relocating the taxilane into Gates 11-17.
- Mon/Sept 21st at 23:30 – Tues/Sep 22nd at 05:00: Taxiway C between Taxiway D and Runway 18/36 will be closed (Taxiway D between Taxiway C and Runway 13R/31L will remain open) for MCM painting taxiway markings on Taxiway D at Taxiway C intersection.
- Wed/Sept 23rd at 2330 – Thur/ Sept 24th at 0500: Runway 13L/31R closed for Airfield Maintenance conducting runway maintenance activities.
- Mon/Sept 21st – Fri/Sept 25th 0900 – 1800: Daily closures of Taxiway D between the approach end of Runway 36 and Runway 13R/31L to paint taxiway markings.

Ongoing Airfield Closures

The following taxiways will remain closed until further notice:

- Taxiway D closed between Taxiway C and D1.
- Taxiway D1, closed as needed from 0700-1700 for work on the shoulder. Taxiway D will be available at Taxiway D1 intersection.
- Taxiway B closed between Taxiway B1 and Taxiway S for MCM pavement work.
- Taxilane P closed for RON C/Taxilane P realignment. RON A realigned to that location and Taxilane P relocated and redesignated Taxiway P

* Please see the airport diagram on the next page for locations of runways and taxiways.

AIRPORT DIAGRAM

AL-106 (FAA)

DALLAS LOVE FIELD (DAL)
DALLAS, TEXAS

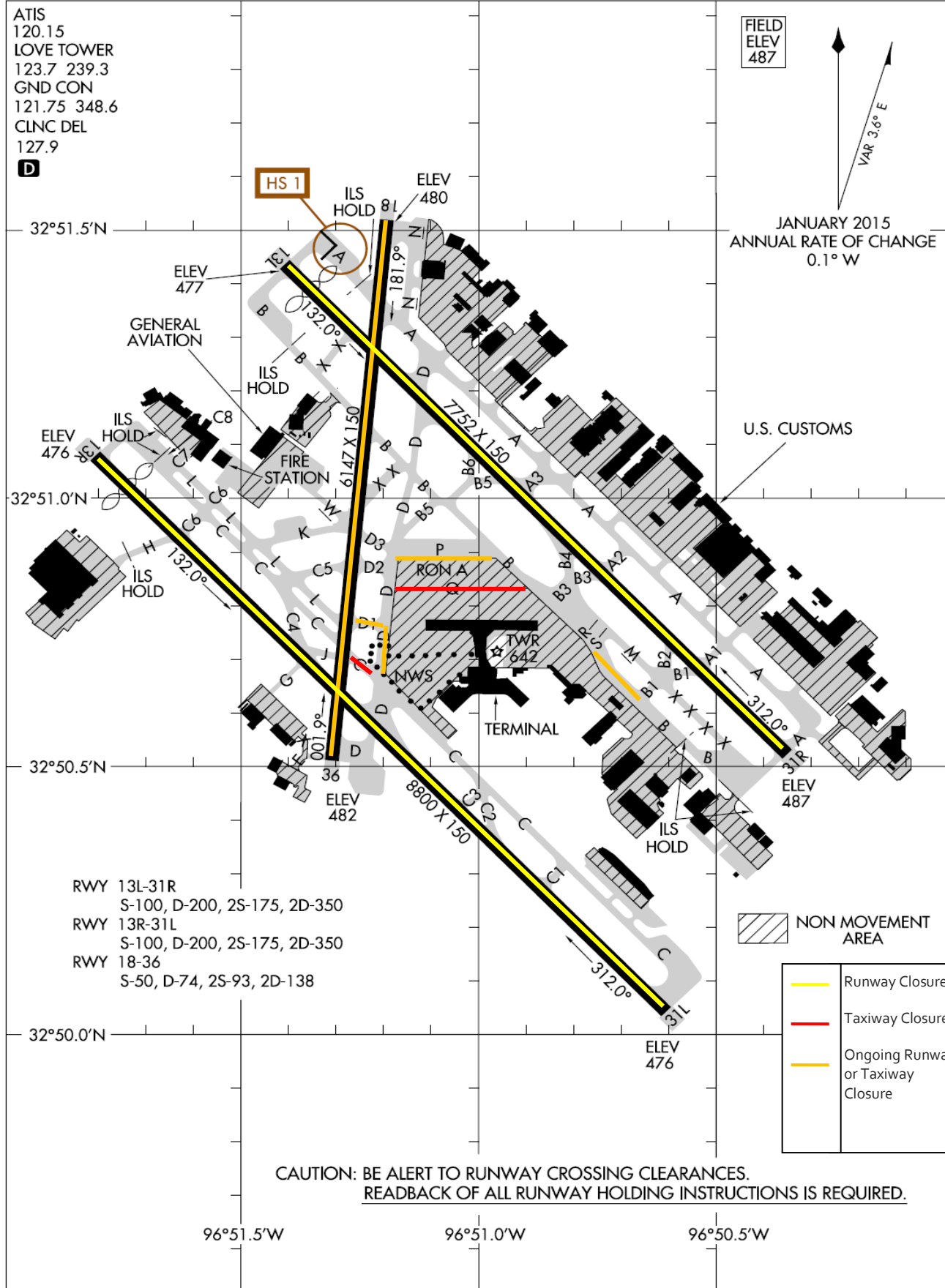

AIRPORT DIAGRAM

15232

DALLAS, TEXAS
DALLAS LOVE FIELD (DAL)

Airport Operations Report

All Operations for the Week of September 6 - September 12

	Runway 13L/31R (Lemmon)				Runway 13R/31L (Denton)			
	13L	31R	Total	Avg/Day	13R	31L	Total	Avg/Day
ARRIVALS	777	332	1109	158	550	401	951	136
COMMERCIAL	417	139	556	79	417	317	734	105
GENERAL AVIATION	255	130	385	55	97	62	159	23
OTHER	105	63	168	24	36	22	58	8
DEPARTURES	606	460	1066	152	732	279	1011	144
COMMERCIAL	244	250	494	71	596	211	807	115
GENERAL AVIATION	244	140	384	55	88	52	140	20
OTHER	118	70	188	27	48	16	64	9

	Combined Operations	
TOTAL ARRIVALS	2060	294
TOTAL DEPARTURES	2077	297
TOTAL OPERATIONS	4137	591

*Total arrival and departure counts include operations that are listed as "unknown" in the system due to radar coverage that doesn't correlate them with a runway in the Noise and Operations Monitoring System.

**Aircraft classified as other include military operations, non-scheduled commercial operations such as charter flights/air taxi, and helicopter operations.

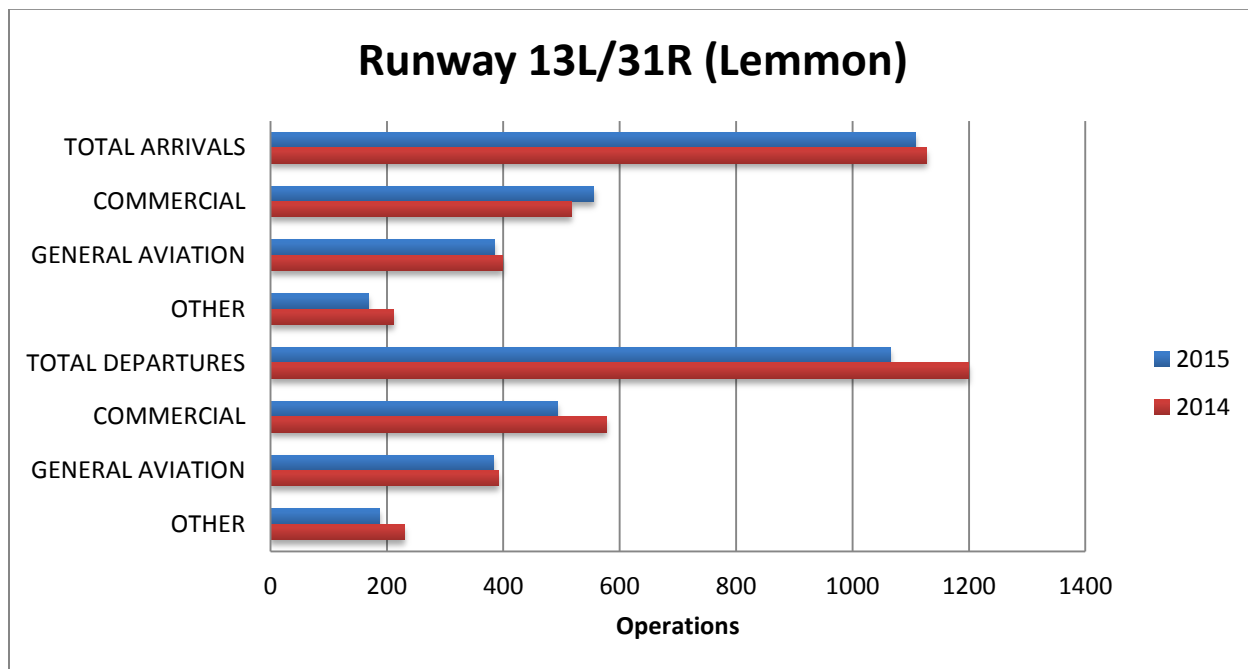

- Sun/Sept. 7, 2014 at 2300 – Mon/Sept. 8, 2014 at 0600: Runway 13L/31R was closed.
- Wed/Sept. 9, 2015 at 2330 – Thur/Sept. 10, 2015 at 0500: Runway 13L/31R was closed.

Airport Operations Report Continued

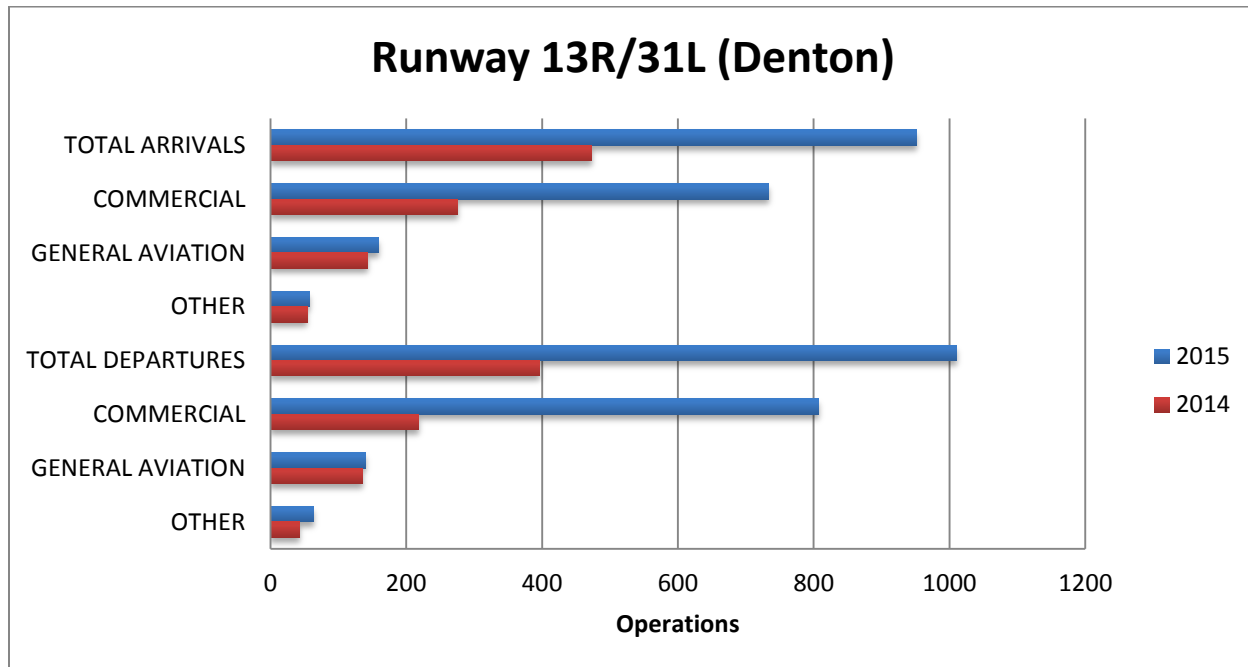

- Wed/Sept. 10, 2014 at 2300 – Thur/Sept. 11, 2014 at 0600: Runway 13R/31L was closed
- Sun/Sept. 6, 2015 at 2330 – Mon/Sept. 7, 2015 at 0500: Runway 13R/31L was closed.

Dallas Love Field

8008 Herb Kelleher Way LB 16

Dallas, Texas 75235

For questions or concerns please contact:

Lanre Olaniyan

Interim Airport Noise Coordinator

214-670-6673

Olanrewaju.Olaniyan@dallascityhall.com

**DALLAS LOVE FIELD
AIRPORT
COMMUNICATION
CENTER**

**ANSWERING ALL YOUR
QUESTIONS AT LOVE FIELD**

**EMAIL 214670LOVE@DALLASCITYHALL.COM
PHONE 214-670-LOVE (5683)**

In an effort to serve you better, Dallas Love Field has opened the Airport Communications Center (ACC) for your use. The ACC is staffed 24 hours a day to direct your airport related concerns. If you are submitting an aircraft noise complaint please call the ACC at 214-670-LOVE (5683). Complaints may also be submitted through the airport's aircraft noise and operations portal, PublicVue. To submit complaints through the PublicVue module, please visit www.dallas-lovefield.com and click on "Aircraft Noise Complaints".