

AIR FORCE ONE
Boeing 707-353B Type: VC-137C
SAM 26000 Serial No: 62-6000

NOVEMBER 22, 1963

- 11:35am Vice President Lyndon B. Johnson's jet, Air Force Two, lands on runway 31[R] and taxis to gate 28A. As a matter of protocol, the Vice President of the United States always lands first to welcome the President of the United States.
- 11:39am President John F. Kennedy's jet, Air Force One, lands on runway 31[R] and taxis to gate 28A. Over 2,000 people gather to welcome the Presidential party. President Kennedy stops and shakes hands with those who came to greet him.
- 11:55am Presidential party departs gate 28A for a motorcade through downtown Dallas and on to the Trade Mart.
- 12:30pm President Kennedy is assassinated in Dealey Plaza in downtown Dallas. Texas Governor John B. Connally, also riding in the President's vehicle is seriously wounded. President Kennedy & Governor Connally are rushed to Parkland Hospital.
- 1:00pm President Kennedy is pronounced dead.
- 1:26pm As a matter of security, US Secret Service orders Vice President Johnson to depart Parkland Hospital en route to Air Force One, before it is publicly announced President Kennedy had died.
- 1:33pm President Kennedy's death announced from Parkland Hospital.
- 1:39pm Vice President & Mrs. Johnson arrive Dallas Love Field and board Air Force One. The Vice President & Mrs. Johnson wait for Mrs. Kennedy and President Kennedy's body to arrive.
- 2:15pm President Kennedy's body and Presidential entourage arrive at Love Field and his body is carried onto Air Force One.
- 2:38pm U.S. Federal Judge Sarah T. Hughes administers the Presidential Oath of Office to Vice President Johnson in the stateroom aboard Air Force One. The swearing in ceremony lasts 28 seconds.
- 2:47pm Air Force One departs Dallas Love Field Airport en route to Andrews Air Force Base near Washington, D.C.

On the occasion of the 50th anniversary of the assassination of President John F. Kennedy, and the first inauguration of President Lyndon B. Johnson, this historical marker is dedicated at the exact site where Air Force One was parked on November 22, 1963.

Gift to the City of Dallas from Farris Rookstool, III
Historian & Former FBI Analyst
November 22, 2013



Dallas Love Field Community Weekly Update

IN THIS ISSUE

Crazy little thing called Love... Field

By: Lanre Olaniyan

Announcements

Thursday, September 3rd, a bronze marker was installed at the spot at Dallas Love Field where Lyndon B. Johnson took the oath of office to become president after the assassination of John F. Kennedy on Nov. 22, 1963. Media was present Thursday to cover the placement of the marker. Make sure to take in a little history on your way through Love Field at Love Landing!

Travel + Leisure's World's Best Awards voted Dallas Love Field No.4 domestic airport in the United States! DAL has shot up the ranks beating mainstays like Charlotte Douglas and Orlando thanks to DAL's great service, art, and food options. #DallasLoveField

You can follow Dallas Love Field on Facebook at:
www.facebook.com/DallasLoveField



Noise Complaints

You may still submit noise complaints to the Department of Aviation through the PublicVue portal on the Love Field website at www.dallas-lovefield.com and clicking the "Aircraft Noise Complaints" button on the right side of the screen. You may also submit complaints via the Airport Communications Center at 214-670-LOVE (5683). The Airport Communications Center (ACC) is staffed 24 hours a day to direct your airport related concerns.

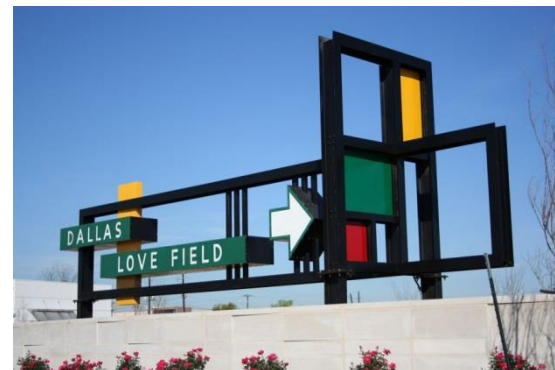

Construction Updates

Page 2

Runway Closures

Page 2

Airport Diagram

Page 3

Airport Operations Report

Pages 4-5

Upcoming LFEAC Meetings...

Thursday October 8, 2015

Thursday January 14, 2016

Thursday April 14, 2016

Construction Updates

Runway Closures

Scheduled Runway and Taxiway Closures

All closures will be coordinated through Airport Operations and will be permitted based on weather and operational impact.

- Tue/Sept 8th at 1800 – Wed/Sept 9th at 0500: Taxiway B between Taxiway B5 and Taxilane Q will be closed for MCM (concrete contractor) /EAS (electrical contractor).
- Tue/Sept 8th at 2330 – Wed/ Sept 9th at 0500: Taxiways B5 and B6 will be between Runway 13L/31R and Taxiway B for Airfield Maintenance painting centerline, enhanced centerline and edge lines.
- Wed/Sept 9th at 2330 – Thur/ Sept 10th at 0500: Runway 13L/31R closed for Airfield Maintenance conducting rubber removal and painting runway hold position markings at Taxiways B3, B4 and B at the departure end of Runway 13L.
- Thur/Sept 10th at 2330 – Fri/Sept 11th at 0500: Taxiway C at Taxiway C4 closed for Airfield Maintenance painting centerline and edge markings.

Ongoing Airfield Closures

The following taxiways will remain closed until further notice:

- Taxiway D closed between Taxiway C and D1.
- Taxiway D1, closed as needed from 0700-1700 for work on the shoulder. Taxiway D will be available at Taxiway D1 intersection.
- Taxiway B closed between Taxiway B1 and Taxiway S for MCM pavement work.
- Taxilane P closed for RON C/Taxilane P realignment. RON (Remain Over Night) A realigned to that location and Taxilane P relocated and redesignated Taxiway P
- Taxiway D between Taxiway B & Taxilane Q, Taxiway B5 between Taxiways B & D and Taxiways D2 & D3 (Taxiway P renamed Taxiway D2) will be closed for 17 days for MCM installing taxiway lighting and other work associated with the relocation of Taxiway P, reopens Fri/Sept 4th at 1800.

*** Please see the airport diagram on the next page for locations of runways and taxiways.**

15064

AIRPORT DIAGRAM

AL-106 (FAA)

DALLAS-LOVE FIELD (DAL)
DALLAS, TEXAS

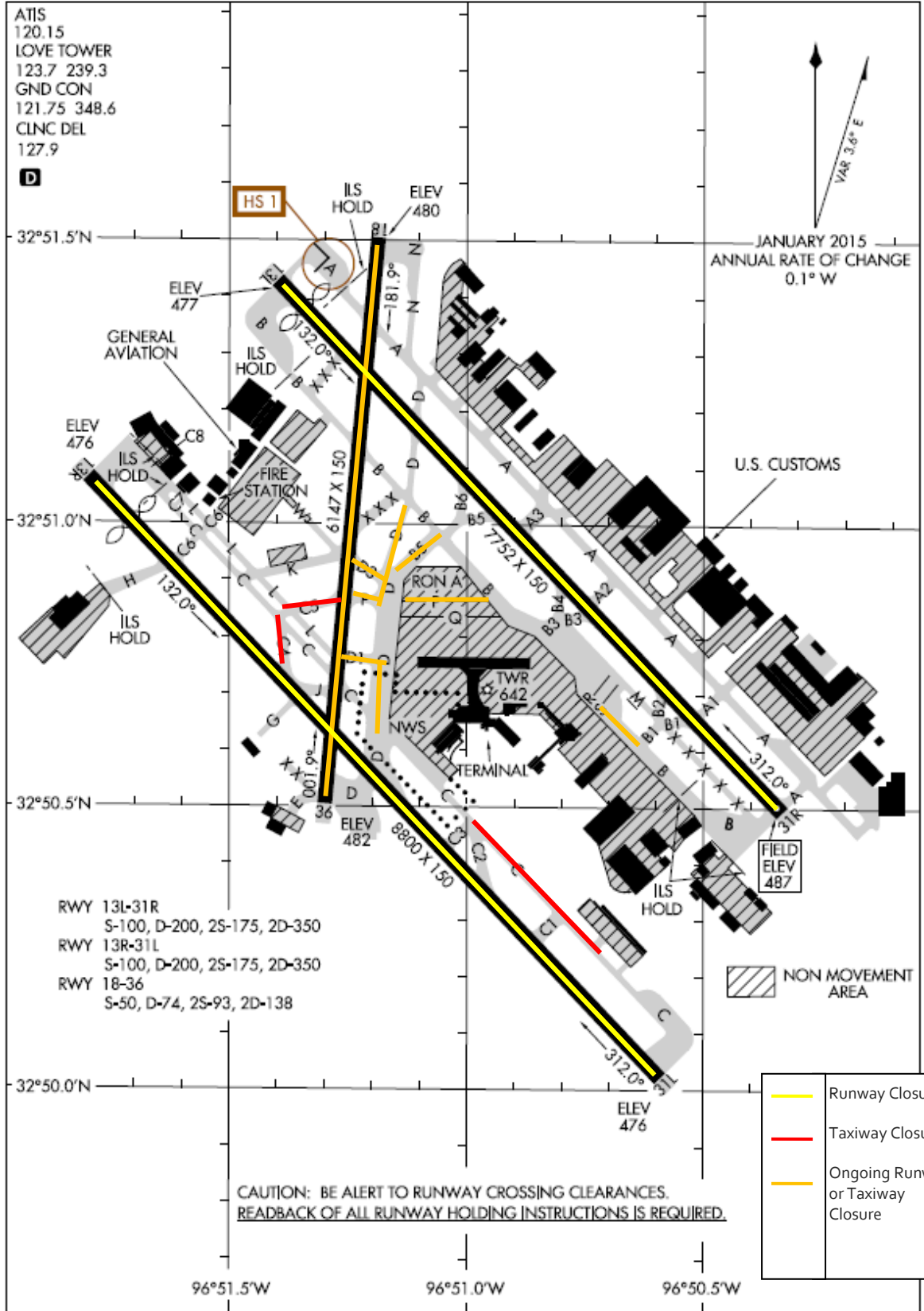

AIRPORT DIAGRAM

15064

DALLAS, TEXAS
DALLAS-LOVE FIELD (DAL)

Airport Operations Report

All Operations for the Week of August 23 - August 29, 2015

	Runway 13L/31R (Lemmon)				Runway 13R/31L (Denton)			
	13L	31R	Total	Avg/Day	13R	31L	Total	Avg/Day
ARRIVALS	1060	156	1216	174	663	141	804	115
COMMERCIAL	630	78	708	101	502	114	616	88
GENERAL AVIATION	294	57	351	50	112	23	135	19
OTHER	136	21	157	22	46	4	50	7
DEPARTURES	831	191	1022	146	907	127	1034	148
COMMERCIAL	385	118	503	72	730	94	824	118
GENERAL AVIATION	296	49	345	49	118	27	145	21
OTHER	150	24	174	25	58	6	64	9

	Combined Operations	
TOTAL ARRIVALS	2020	289
TOTAL DEPARTURES	2056	294
TOTAL OPERATIONS	4076	582

*Total arrival and departure counts include operations that are listed as "unknown" in the system due to radar coverage that doesn't correlate them with a runway in the Noise and Operations Monitoring System.

**Aircraft classified as other include military operations, non-scheduled commercial operations such as charter flights/air taxi, and helicopter operations.

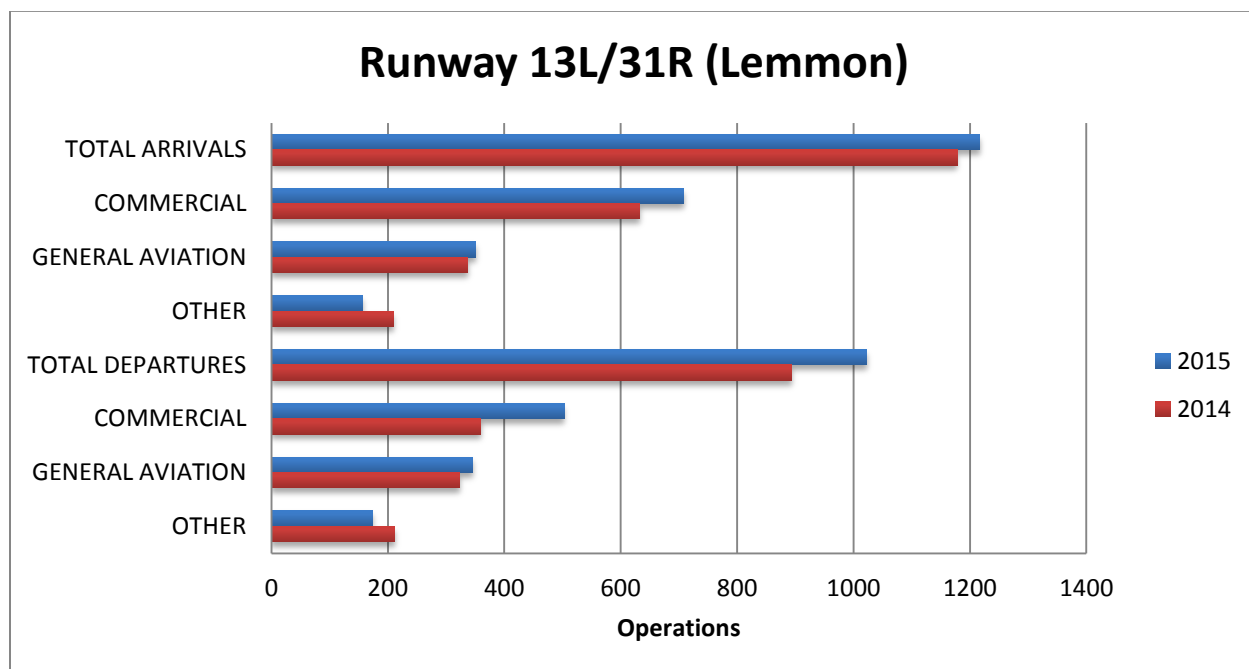

- Sat/Aug 23, 2014 at 0700 – 1900: Runway 13L/31R was closed.
- Sun/Aug 24, 2014 at 0700 – 1400: Runway 13L/31R was closed.
- Sun/Aug 24, 2014 at 2300 – Mon/Aug 25, 2014 at 0530: Runway 13L/31R was closed.
- Wed/Aug 26, 2015 at 2330 – Thur/Aug 27, 2015 at 0500: Runway 13L/31R closed

Airport Operations Report Continued

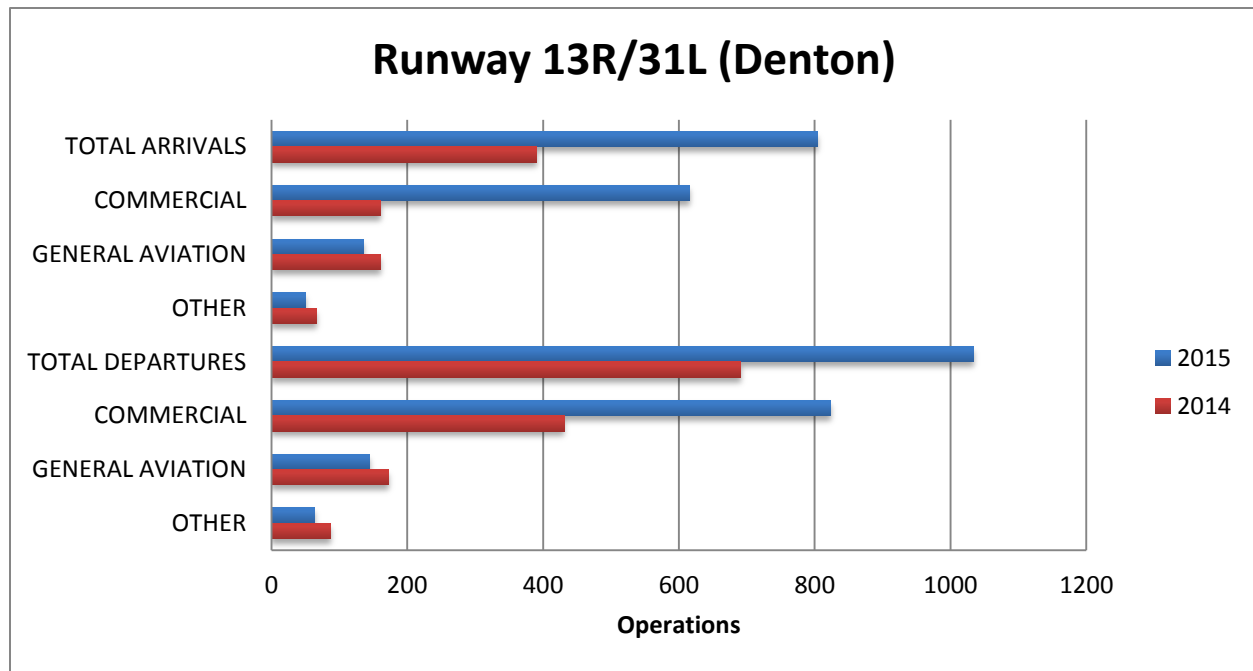

- Mon/Aug 25, 2014 at 1100 – 1300: Runway 13R/31L was closed
- Wed/ Aug 27, 2014 at 2300 – Thu/Aug 28 at 0530: Runway 13R/31L was closed
- TWY C between C2 and D closed to aircraft August 2014
- Sun/Aug 23, 2015 at 2330 – Mon/Aug 24, 2015 at 0500: Runway 13R/31L was closed.

Dallas Love Field

8008 Herb Kelleher Way LB 16

Dallas, Texas 75235

For questions or concerns please contact:

Lanre Olaniyan

Interim Airport Noise Coordinator

214-670-6673

Olanrewaju.Olaniyan@dallascityhall.com



**DALLAS LOVE FIELD
AIRPORT
COMMUNICATION
CENTER**

**ANSWERING ALL YOUR
QUESTIONS AT LOVE FIELD**

**EMAIL 214670LOVE@DALLASCITYHALL.COM
PHONE 214-670-LOVE (5683)**

In an effort to serve you better, Dallas Love Field has opened the Airport Communications Center (ACC) for your use. The ACC is staffed 24 hours a day to direct your airport related concerns. If you are submitting an aircraft noise complaint please call the ACC at 214-670-LOVE (5683). Complaints may also be submitted through the airport's aircraft noise and operations portal, PublicVue. To submit complaints through the PublicVue module, please visit www.dallas-lovefield.com and click on "Aircraft Noise Complaints".